

FRONT ELEVATION
NOT TO SCALE

SIDE VIEW
NOT TO SCALE

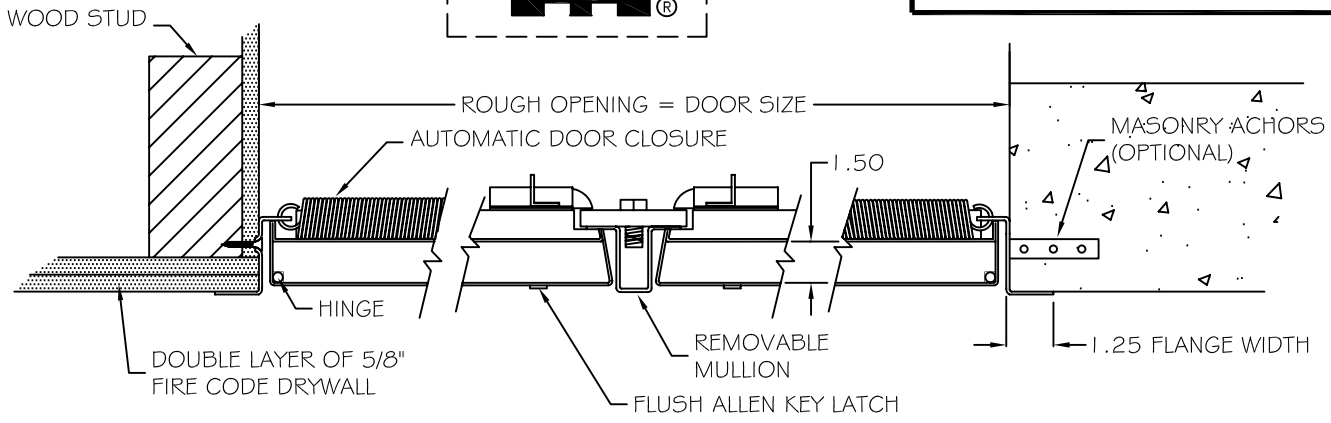

- SPECIFICATIONS**
- 16 GA GALVANIZED STEEL FRAME
 - 18 GA GALVANIZED STEEL DOOR AND 22 GA LINER
 - 1.25" FLANGE
 - 2.25" FRAME DEPTH
 - CONCEALED CONTINUOUS ROD HINGE OPENING TO 100°
 - SELF CLOSING, SELF LATCHING
 - STANDARD .25" ALLEN HEAD LATCH
 - STANDARD INTERIOR LATCH RELEASE MECHANISM
 - WHITE ELECTROSTATICALLY APPLIED RUST INHIBITIVE PRIME COAT
 - 2 HOUR FIRE RATING FOR HORIZONTAL AND VERTICAL INSTALLATION
- MAXIMUM SIZE:
60" X 48"
- OPTIONS**
- STAINLESS STEEL W/#4 SATIN POLISH FINISH
 - CYLINDER KEY LOCK WITH TUBULAR KEYWAY
 - 3 HOUR RATING FOR HORIZONTAL INSTALLATION (DOOR WILL COME WITH 2 1/2" INSULATION)



SECTION ELEVATION
NOT TO SCALE