

INSTALLATION & MAINTENANCE: CGS SERIES CORNERGUARDS

STORAGE, HANDLING & ENVIRONMENTAL CONDITIONS:

All materials shipped unassembled. Store vertically or on flat horizontal surface.

INSTALLATION:

- Make sure the wall where corner guards are to be attached is smooth and clean so the corner guard will fit tight against the corner.
- The top of the corner guard will have rounded edges while the bottom of the corner guard will have square edges.

SCREW ATTACHMENT:

Place the corner guard in position. Attach with screws provided alternating sides and positions to avoid bowing.

ADHESIVE ATTACHMENT:

Construction Adhesive Installation:

1. Construction Adhesive: - Apply a 1/4" bead of heavy duty adhesive in a zigzag pattern on the back of the cornerguard.
2. Position corner guard on the wall and apply pressure until a tight fit is achieved. Support cornerguard in place until adhesive is cured.
3. Coverage: 10 fl. oz cartridge with a 1/4" bead extrudes approximately 30 ft.

Adhesive Tape Installation:

1. Apply Tape: Apply double sided tape to the back of the cornerguard approximately 1/16" from the edge.
2. Position corner guard on the wall and apply pressure until a tight fit is achieved.

CLEANING AND MAINTENANCE:

Use a soft cloth and a good metal cleaner. We recommend Mr. Metal by Northern Labs.

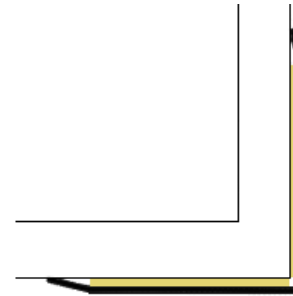

Application of Liquid Adhesive

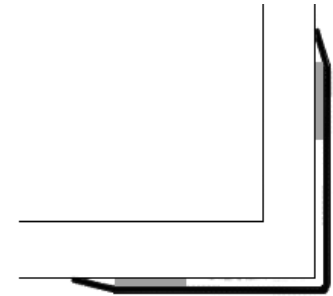

Application of Mounting Tape

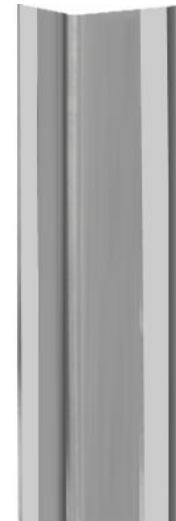

JL INDUSTRIES



**INSTALLATION & MAINTENANCE:
CGS SERIES CORNERGUARDS**

© 2022 Activar Construction Product Group, Inc.

HEADQUARTERS & CUSTOMER SERVICE: 9702 NEWTON AV S, BLOOMINGTON, MN 55431 MANUFACTURING: COMMERCE, CA & BLOOMINGTON MN WAREHOUSES: SEE WEBSITE FOR LOCATIONS

2/2/2022