

- ☑ Model 962 – Recess-Mounted **Bradex**®
- ☑ Model 962-11 – Surface-Mounted **Bradex**®
- ☑ Meets relevant sections of the CPSIA to the extent possible.
- ☑ Meets or exceeds ASTM F2285 Safety Specification for Commercial Changing Stations.

## Product Materials

**BODY:** bacterial-resistant polyethylene with brushed 20 gauge stainless steel exterior. Rated to support static load of 250 lbs, tested to 390 lbs. Pneumatic gas shock mechanism to ensure smooth, safe open and close motions.

**MOLDED DUAL LINER DISPENSER:** holds approx. 50 per dispenser (liners sold separately).

**SAFETY BELT:** with cam-buckle, adjustable with one hand.

**⚠ WARNING:** Be sure to use reinforced backing behind wall where mounting screws or anchoring devices are installed to ensure adequate support for the baby changing station. All anchoring devices (supplied by installer) must be appropriate for specific wall construction. Severe personal injury and/or property damage may result from improper mounting.

## ADA Compliant

- ☑ Consult local and national accessibility codes for proper installation guidelines.
- ☑ Conformity and compliance to local and national codes is the responsibility of the installer.

## Service Parts Available

| Part Number | Description                               |
|-------------|---|
| P11-021     | Liners (100% bio-degradable), Case of 500 |

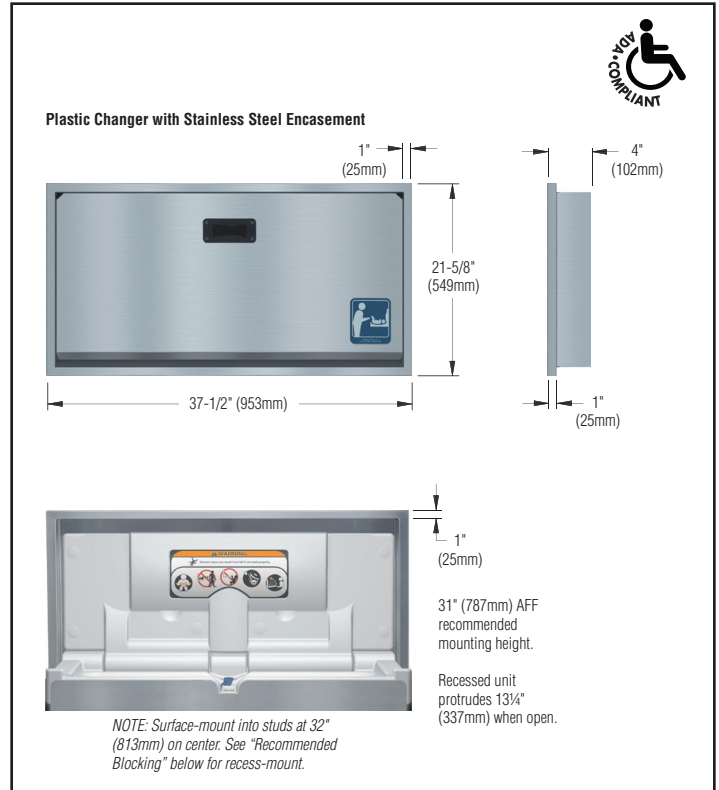

Washroom Accessories  
 Document No. 9033

Orders composed of products indicated as **Bradex**® will be available to ship in three days after receipt of order at the factory. There is no pricing penalty for this service from Bradley. This information is subject to change without notice. 4-25-2011

Distributed by  
[www.AmeraProducts.com](http://www.AmeraProducts.com)  
 Phone: (800) 608-6568  
 Fax: (409) 840-5545  
[info@ameraproducts.com](mailto:info@ameraproducts.com)

