

SOAP DISPENSER

- Urn Type Liquid Soap Dispenser
- Surface Mounted

Bradex™

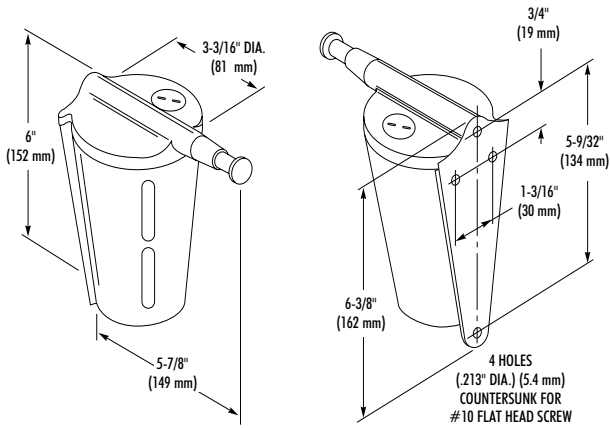

CONSTRUCTION:

- **CONTAINER CASE** of high polish chrome plated brass. Filler hole cover secured to unit with chain.
- **SOAP CONTAINER** is plastic.
- **SOAP VALVE** piston assembly of chrome-plated plastic. Rear valve assembly of Delrin with Neoprene seal.
- **WALL PLATE** is full length, heavy gauge plated steel.

CAPACITY:

12 oz. liquid soap.

OPERATION:

Pump type valve dispenses a measured amount of liquid soap with each stroke. Viewing slots in case reveal soap level. Filler hole cover, with locking chain, requires special wrench to open.

NOTE: Bradley liquid and lather soap valves operate best with any vegetable oil or Coconut oil hand soap having a 10 to 15 percent soap concentration.

INSTALLATION:

Secure separate mounting bracket to wall. Attach soap dispenser.

OPTIONAL FEATURES:

Feature	Suffix
<input type="checkbox"/> Lather valve in lieu of liquid	-13

GUIDE SPECIFICATION:

Surface mounted soap dispenser shall have pump type valve with 1/2" diameter chrome-plated plastic piston assembly in chrome plated housing. Soap level in plastic container shall be visible through viewing slots in chrome plated brass case. Dispenser shall have completely concealed mounting and vandal-proof filler hole cap. Capacity: 12 oz. liquid soap.

Overall dimensions: 3-3/16"W x 6"H x 5-7/8"D (from wall to end of valve).

Surface Mounted Liquid Soap Dispenser shall be Bradley Model 657.