

FRONT ELEVATION
NOT TO SCALE

SIDE VIEW
NOT TO SCALE



SPECIFICATIONS

- 16 GA GALVANIZED STEEL FRAME
- 18 GA GALVANIZED STEEL DOOR AND 22 GA LINER
- 1.25" FLANGE
- 2.25" FRAME DEPTH
- CONCEALED CONTINUOUS ROD HINGE OPENING TO 100°
- SELF CLOSING, SELF LATCHING
- STANDARD .25" ALLEN HEAD LATCH
- STANDARD INTERIOR LATCH RELEASE MECHANISM
- WHITE ELECTROSTATICALLY APPLIED RUST INHIBITIVE PRIME COAT
- 2 HOUR FIRE RATING FOR HORIZONTAL AND VERTICAL INSTALLATION

MAXIMUM SIZE:
60" X 48"

OPTIONS

- STAINLESS STEEL W/#4 SATIN POLISH FINISH
- CYLINDER KEY LOCK WITH TUBULAR KEYWAY
- 3 HOUR RATING FOR HORIZONTAL INSTALLATION (DOOR WILL COME WITH 2 1/2" INSULATION)

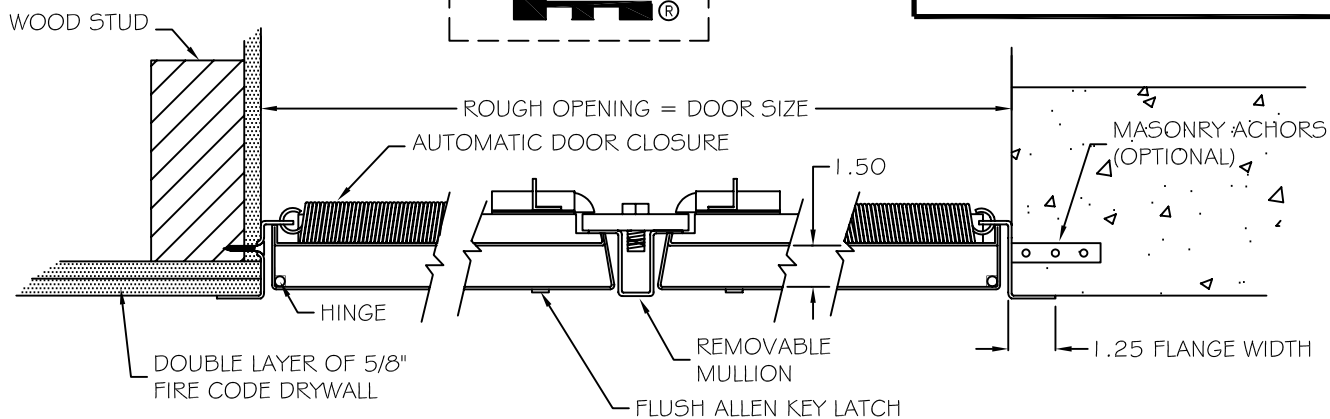

SECTION ELEVATION
NOT TO SCALE