

REV.	DESCRIPTION	DATE	APPROVED
0	Initial Release	1/5/2009	JXxxx
1	A.F.F. height change: 50.25in to 48.0in top-mounting hole	2/06/13	LP

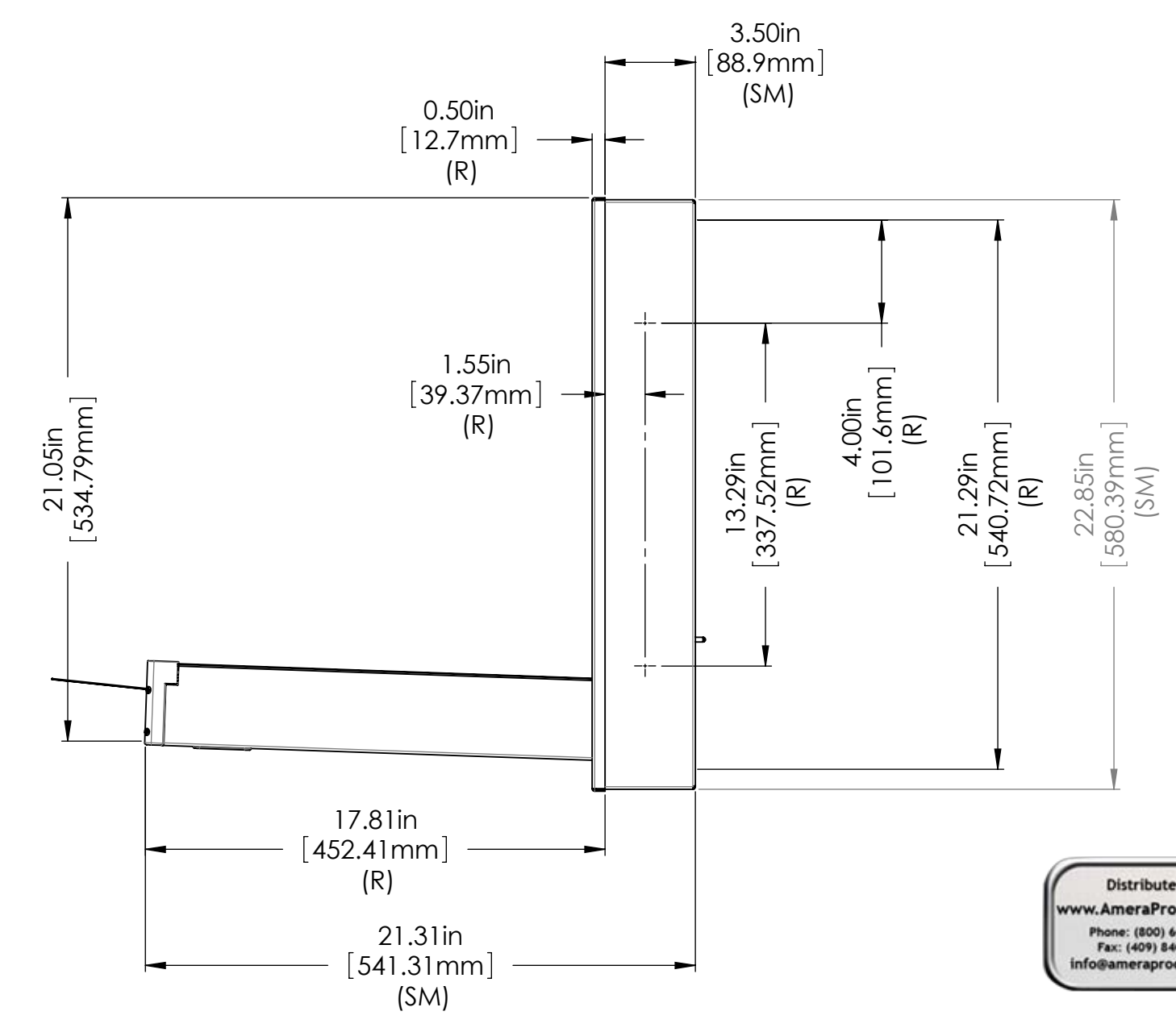
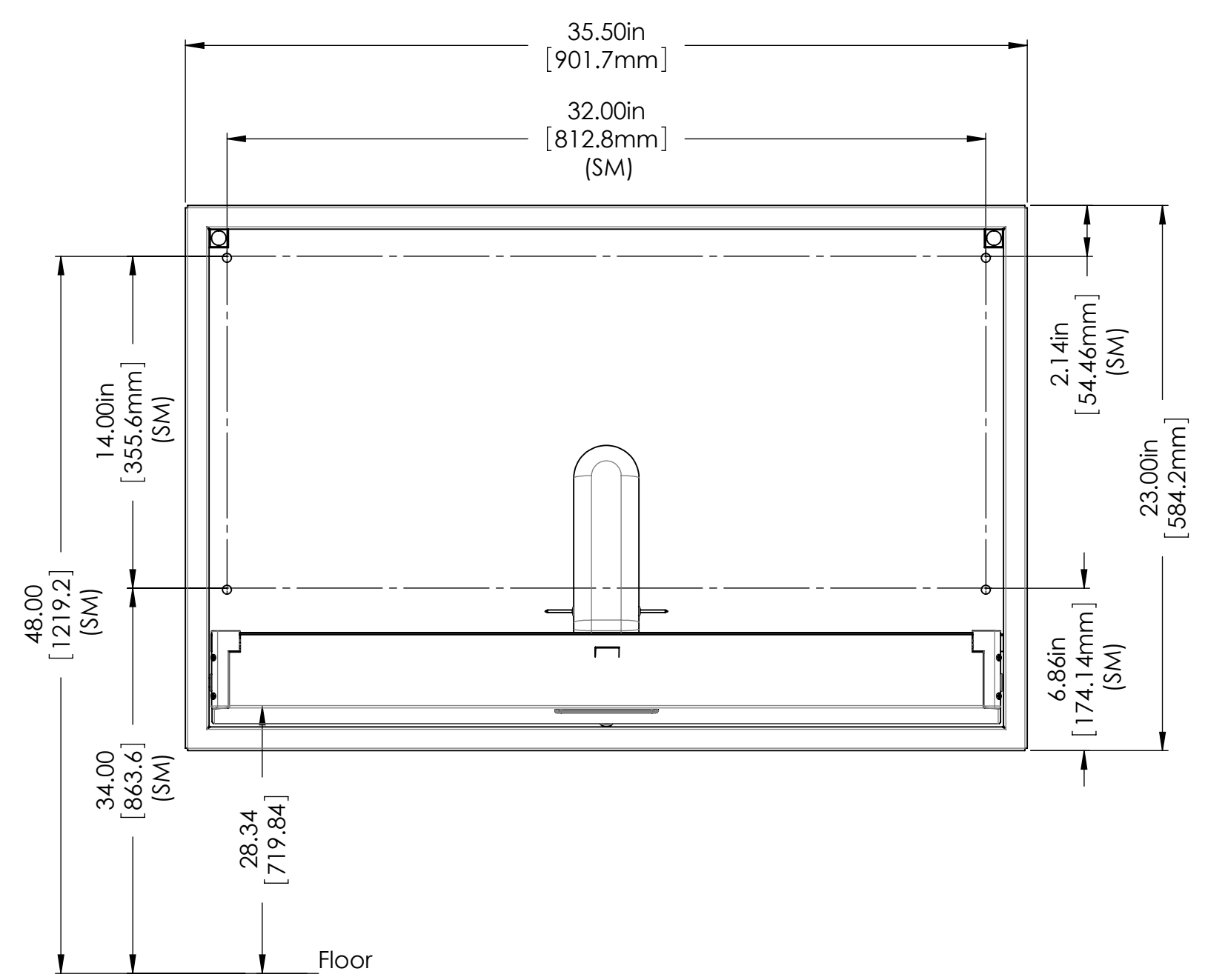
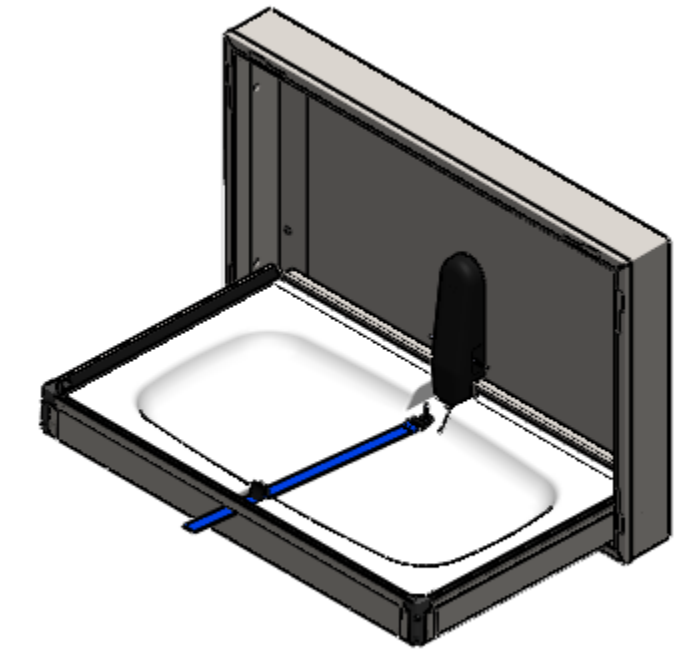
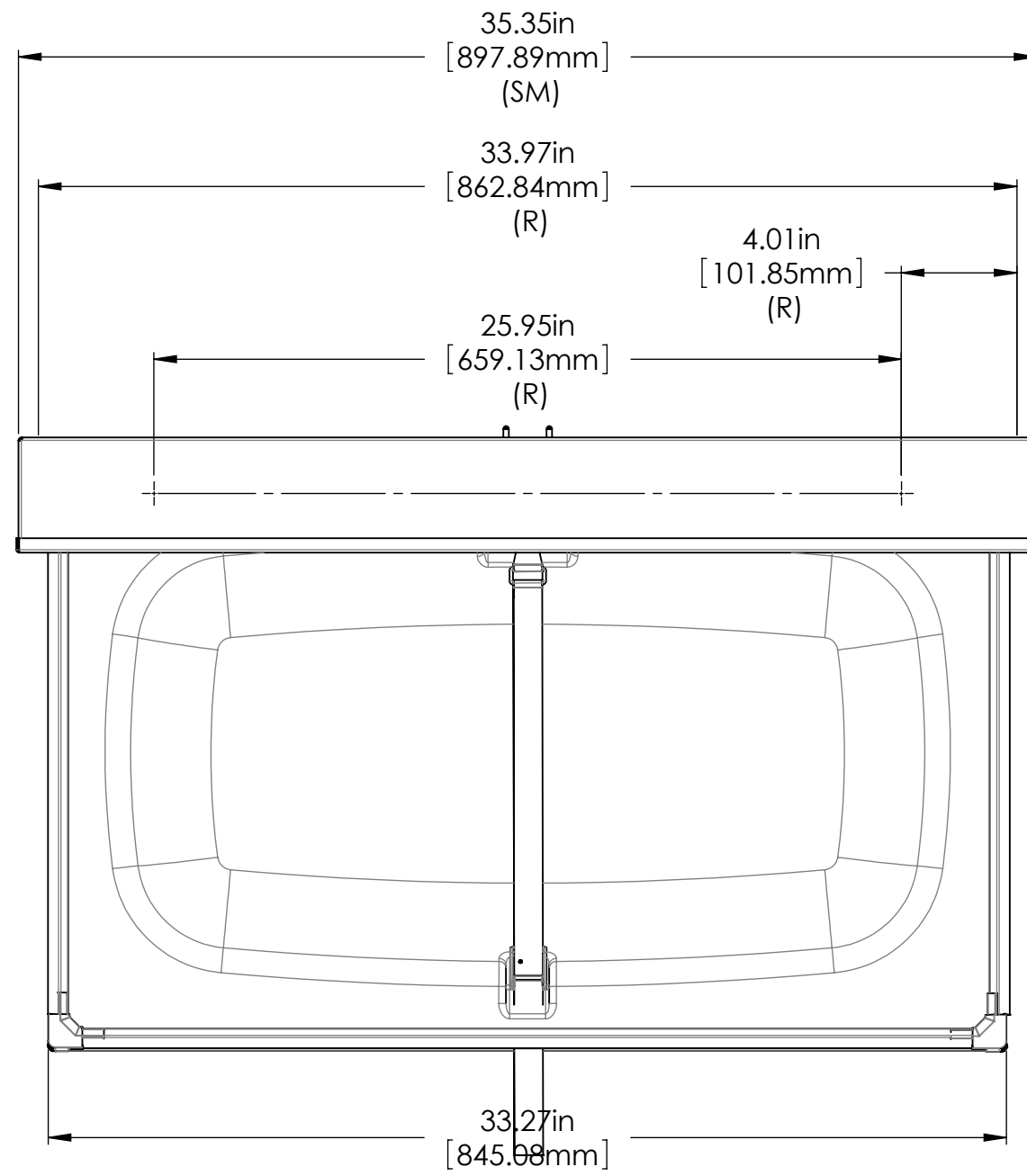

Distributed by  
www.AmeraProducts.com  
Phone: (800) 608-6548  
Fax: (409) 840-5545  
info@ameraproducts.com

DIMENSIONAL TOLERANCES: (UNLESS OTHERWISE SPECIFIED) FRACTIONAL: $\pm \frac{1}{32}$ " MACHINED ANGLES: $\pm 0.5^\circ$ BEND ANGLES: $\pm 1.0^\circ$ 0.XX: $\pm 0.040$ in [1mm] 0.XXX: $\pm 0.0150$ in [0.38mm]			
MATERIAL: N/A		DESCRIPTION: Architectural Layout for 100SS	
FINISH: N/A	PART NO: Arch - 100 SS	SCALE: NTS	REV: 1
	DRAWN BY: JXxxx	DATE: 1/4/2009	SHEET: 1 OF 1
PROPRIETARY AND CONFIDENTIAL THE INFORMATION CONTAINED IN THIS DRAWING IS THE EXCLUSIVE PROPERTY OF FOUNDATIONS WORLDWIDE, INC. ANY REPRODUCTION OR USE OF THIS DRAWING, IN PART OR IN WHOLE WITHOUT THE EXPRESSED PERMISSION OF FOUNDATIONS WORLDWIDE, INC IS PROHIBITED.			

Notes:  
SM - Surface Mount  
R - Recessed Mount